

LEGENDA	
TAG	DESCRIERE
	ACCES PIETONAL
	ACCES AUTO
	LIMITA PARCELA
	SPATIU VERDE

LEGENDA CAMERE				
CAMERA	ARIE UTILA	FINISAJE TAVAN	FINISAJE PARDOSELI	FINISAJE PERETI
HOL INTRARE	5.47 mp	vopsitorie decorativa	placare ceramica	vopsitorie decorativa
CAMERA TEHNICA	4.34 mp	vopsitorie decorativa	placare ceramica	vopsitorie decorativa
BUCATARIE	10.30 mp	vopsitorie decorativa	placare ceramica	vopsitorie decorativa
G.S.	2.31 mp	lavabila	placare ceramica	placare ceramic
HOL CASA SCARII	3.33 mp	vopsitorie decorativa	placare ceramica	vopsitorie decorativa
DINING	9.18 mp	vopsitorie decorativa	parchet stratificat	vopsitorie decorativa
LIVING	24.25 mp	vopsitorie decorativa	parchet stratificat	vopsitorie decorativa
TERASA STRADA	10.79 mp	-	placare ceramica	-
TERASA	19.07 mp	-	placare ceramica	-

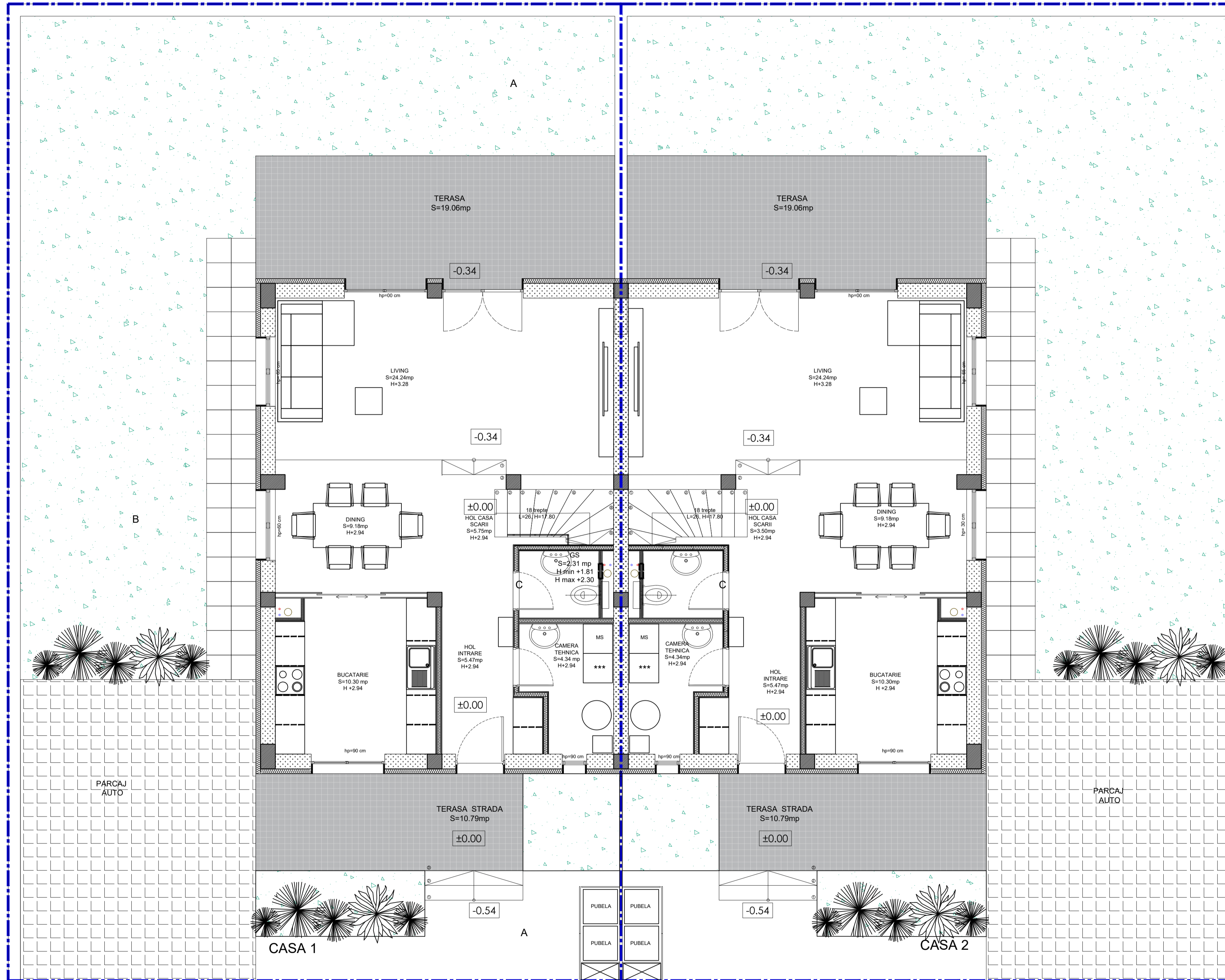

Incarcari in norme si clasificari ale cladirii:  
 • Categoria de importanta a constructiei D redusa conform HGR 766/1997 cu modificari si completari de rigiote si cu metodologia specifica  
 • Clasa de importanta a constructiei 4 conform P100/2013  
 • Grad de rezistenta la foc IV conform P118/1999  
 • Risic de incendiu: MIC  
 • Destinatie: Locuinte unifamiliale cuplate  
 • Regim de inaltime: P+1+M

Verificator	Cerinta	Stampa, data, semnatura

Proiectant de specialitate / Specialized designer	Denumire proiect / Project title	Adresa / Address
<b>INFINITY</b> DESIGN OFFICE	Construire a unitatii locale, cuplate 2 cate 2, p+1+m, imprejurire, bransamente utilitati 2 dwelling units, coupled 2 by 2, ground floor for floor utility, embasement utility connections	Str. Muntelui, Nr. 45, Str. Compuului Nr. 20, Vata 24, Parcela 323, C/parc 139, Parcela 4487, 4490, 4491, 4488, 4489, 4492, Oras Otopeni, Judet Ilfov
Sef de proiect / Chief Designer	Arh. Alexandra Ghindoc	Beneficiar / Client S.C. BALVASI CONSTRUCT SRL
Proiectat de / Drawn by	Arh. Alexandra Ghindoc	Titlu planșă / Drawing title Plan parter mobilat / furnished ground floor plan
Desenat de / Designed by	Arh. Alexandru Ion	Faza / Phase DTAC
Desenat de / Drawn by		Scara / Scale 1:50
Nr. Proiect / Project No.	22062021	Revizii / Revisions X X
Emisitor / Issued by	INFINITY	
Disciplina / Discipline	Arhitectura / Architecture	
Data / Date	05.2021	
Cod planșă / Drawing code	A01-02	

**Note generale / General notes:**

- Drepturile de autor sunt protejate prin lege.
- Pentru obiectivele care necesita autorizatie de construire acest desen nu se poate folosi pentru executie inainte de obtinerea acesteia.
- Antreprenorul general/constructorul va verifica toate cotele si dimensiunile. Eventualele erori sau omisiuni vor fi semnate proiectantului general inainte de construire.
- Dimensiunile nu se vor masura direct pe acest desen.
- Listele de cantitati se vor verifica impreuna cu planurile.
- Securitatea si fatzele se vor citi impreuna cu planurile.
- Oricand respectiv in proiect si situatiile constructive vor fi semnate pe parcursul executiei, iar solutiile constructive adoptate vor constitui obiectivul unor comunicari de sanatate.
- Antreprenorul general/constructorul se obliga sa anunte proiectantul daca apar neclaritati pe santier sau daca dimensiunile si/sau detaliile lipsesc din desene inainte de incepere lucrurilor de executie.
- Toate materialele si modurile de implementare a solutiilor din proiect vor fi conform codurilor specifice romanesti si europene.
- Cotele sunt conform proiect. La punerea in opera, executantul va efectua releveu pentru actualizarea cotelor.
- Antreprenorul general/constructorul va lua toate masurile de protectie a muncii si PSI prevazute de legislatia in vigoare.
- Copyright is protected by law.
- For objectives that require a building permit, this drawing cannot be used for execution before obtaining it.
- The general contractor/builder will check all dimensions. Any error or omissions will be reported to the general designer before construction.
- Dimensions will not be measured directly on this drawing.
- The bill of quantities will be checked together with the layouts.
- Factors and facades will be read together with the layouts.
- Any mismatch between the project and the constructive situations will be signalled during the execution, and the constructive solutions adopted will be the objective of site communications.
- The general contractor/builder undertakes to notify the general designer if there are any ambiguities on the site or if the dimensions and/or details are missing from the drawings before the start of the execution works.
- All the materials and the way of implementing the solutions from the project will be according to the specific Romanian and European codes.
- Dimensions are according to the project. Upon implementation, the builder will make a survey to update the dimensions.
- The general contractor/builder will take all labor protection and PSI measures provided by legislation in effect.